

J	MOTOR LISTER	GMB 11
I	MOTOR HATZ E71	GMB 10
H	MOTOR DETROIT DIESEL 371	GMB 8
G	MOTOR DETROIT DIESEL 371	GMB 7
F	MOTOR CATERPILLAR D399	GMB 6
E	MOTOR CATERPILLAR D399	GMB 5
D	MOTOR CATERPILLAR 3412	GMB 4
C	MOTOR CATERPILLAR 3412	GMB 3
B	MOTOR DETROIT DIESEL 8V - 92	GMB 2
A	MOTOR DETROIT DIESEL 8V - 92	GMB 1
20	MOTOR ELECTRICO (WINCHE)	T. 1002.44
19	GENERADOR 2	G.T. 002.44
18	GENERADOR 1	G.T. 001.44
17	MOTOR ELECTRICO (ZARANDA)	T. 502.44
16	MOTOR ELECTRICO (ZARANDA)	T. 501.44
15	MOTOR ELECTRICO (MEZCLADOR 04)	T. 704.44
14	MOTOR ELECTRICO (MEZCLADOR 03)	T. 703.44
13	MOTOR ELECTRICO (MEZCLADOR 02)	T. 702.44
12	MOTOR ELECTRICO (MEZCLADOR 01)	T. 701.44
11	MOTOR ELECTRICO (DESGASIFICADOR)	T. 1001.44
10	MOTOR ELECTRICO (B.O.P.)	T. 2005.44
9	MOTOR ELECTRICO (BOMBA DE AGUA 2)	T. 2004.44
8	MOTOR ELECTRICO (BOMBA DE AGUA 1)	T. 2003.44
7	MOTOR ELECTRICO (COMPRESOR 2)	T. 2002.44
6	MOTOR ELECTRICO (COMPRESOR 1)	T. 2001.44
5	MOTOR ELECTRICO (QUIMICA)	T. 5004.44
4	MOTOR ELECTRICO (QUIMICA)	T. 5003.44
3	MOTOR ELECTRICO (DESARENADOR)	T. 5002.44
2	MOTOR ELECTRICO (DESILTER)	T. 5001.44
1	MOTOR ELECTRICO (HIDRAULICO)	T. 60012.44
ITEM	DESCRIPCION	CODIGO

GMB S.A.

ESCALA: 1:150	DIAGRAMA DE DISTRIBUCION DE COMPONENTES DEL EQUIPO 44	FECHA 18-02-92
HECHO POR: MNL	REVISADO: JRC	60

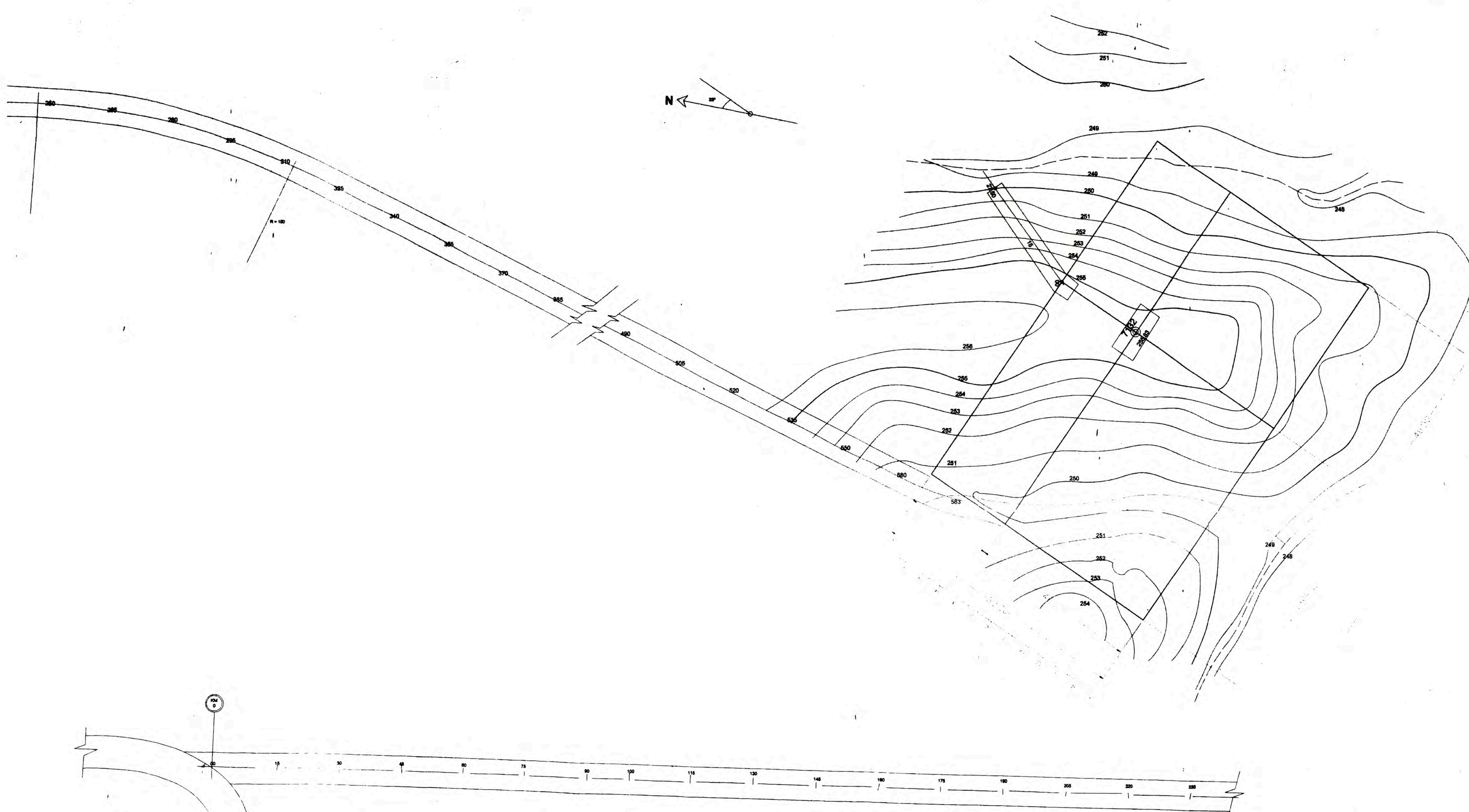

COTA SUBRASANTE PLATAFORMA = 252.10

GRAÑA Y MONTERO . BLOCKER S.A.		GMB	
PLANO:			
LEVANTAMIENTO TOPOGRAFICO PLATAFORMAS Y CAMINOS			
PROPIETARIO:			
PETROLEOS DEL PERU			
SUPERVISION:			
CIA. NAVIERA PEREZ COMPANC			
ESCALA:	1/500	LEVANTI:	H. CORNEJO S.
FECHA:	NOV 1994	REV:	
DIBUJO:	J. ESPINOZA B	APROB:	
		PL. N.º	POZO N.º
		61	7132

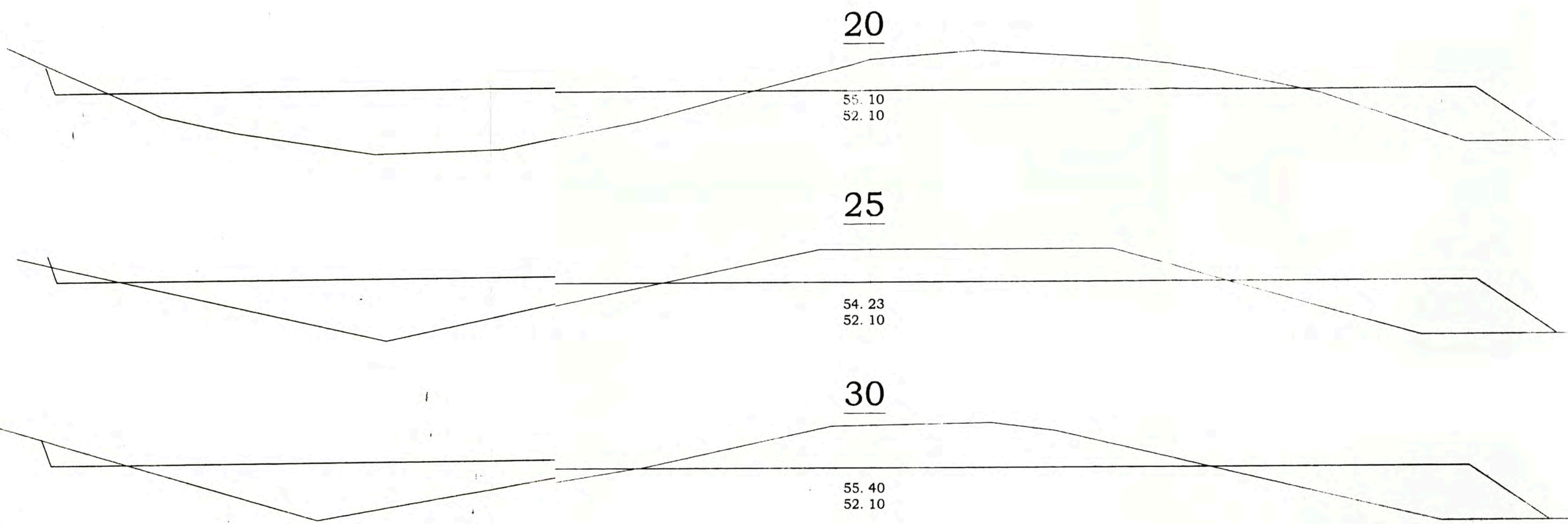
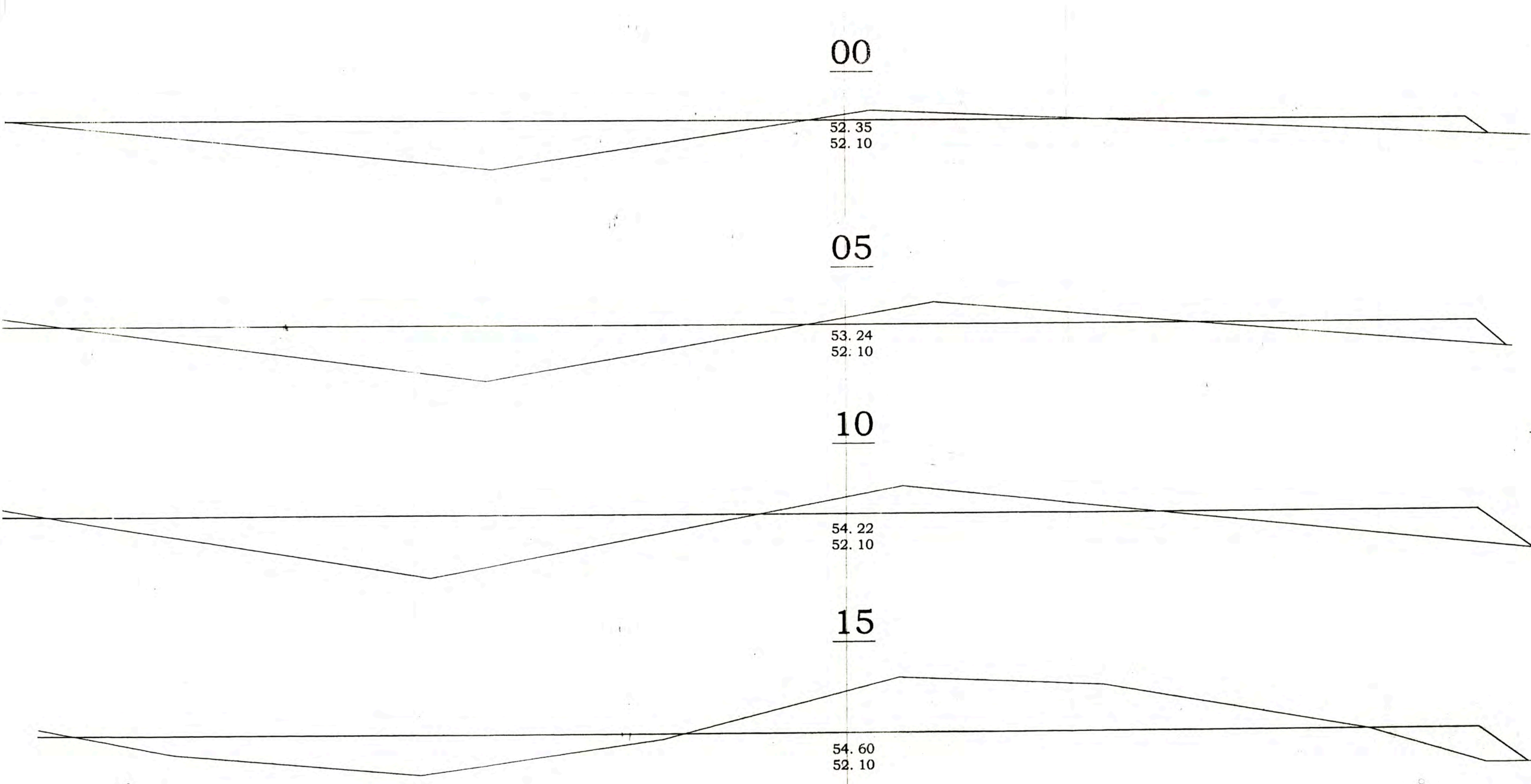

GRAÑA Y MONTERO . BLOCKER S.A.		GMB	
PLANO: SECCIONES TRANSVERSALES . PLATAFORMA			
PROPIETARIO: PETROLEOS DEL PERU			
SUPERVISION: CIA. NAVIERA PEREZ COMPANC			
ESCALA: 1:200	LEVANT: H. CORNEJO	PLAN: 62	HOZON: 7132
FECHA: NOV 1994	DIR.:		

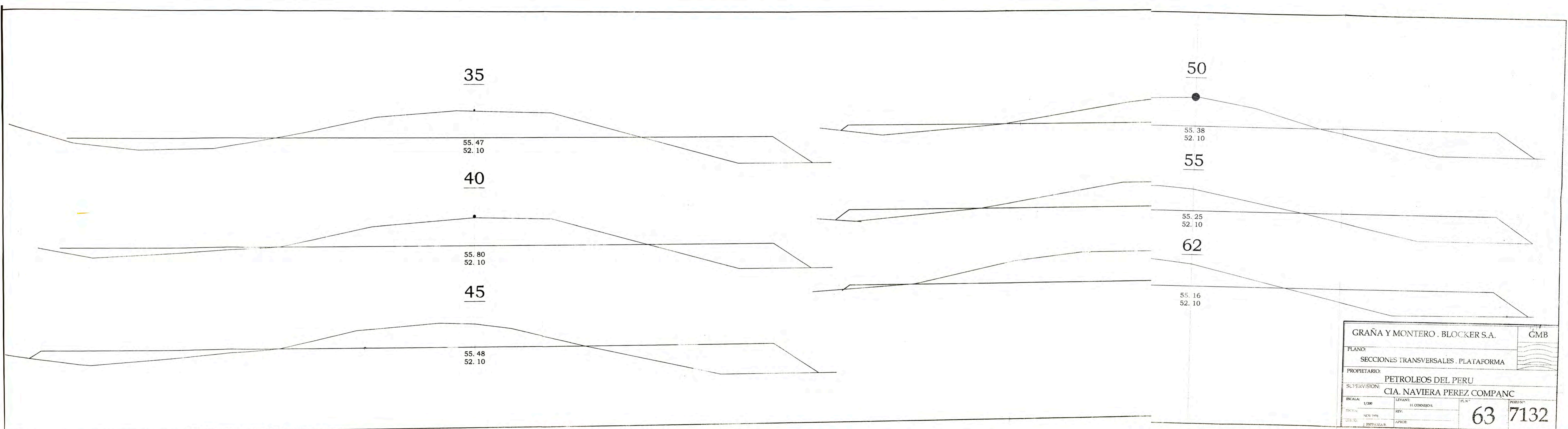

50

55.38
52.10

55

55.25
52.10

62

55.16
52.10

35

55.47
52.10

40

55.80
52.10

45

55.48
52.10

GRAÑA Y MONTERO . BLOCKER S.A.		GMB	
PLANO: SECCIONES TRANSVERSALES . PLATAFORMA			
PROPIETARIO: PETROLEOS DEL PERU			
SUPERVISION: CIA. NAVIERA PEREZ COMPANC			
ESCALA: 1/200	LEVANTE: H. CORNEJO S.	PLAN N°	POZO N°
FECHA: NOV 1994	REV:	63	7132
DESB: J. ESPINOZA B.	APROB:		

270

260

250
266.00
264.26
259.00
256.60

C.v = 40m
-0.00
-0.06
-0.33
-0.18
-0.00

PLATAFORMA

PENDIENTES

ALTURA CORTE

ALTURA RELLENO

COTA SUBRASANTE

COTA TERRENO

DISTANCIA ACUMULADA

KILOMETRAJE

		-1.74 % X 100 M										-2.768 % X 190 M										-1.14 % X 210 M										-5.42 % X 83 M										
	--	--	0.01	--	--	0.01	--	--	--	0.50	0.20	--	--	--	0.14	0.11	0.19	0.23	0.26	0.25	0.18	0.06	--	--	--	0.03	0.20	0.33	0.61	1.02	1.51	0.63	--	--								
	--	0.01	--	--	0.01	--	--	--	--	0.68	0.54	--	0.39	--	0.47	0.53	--	--	0.11	0.06	--	--	0.07	0.03	--	--	--	--	--	--	--	1.01	1.85	1.59								
	266.00	65.74	65.48	65.22	64.96	64.70	64.43	64.26	63.84	63.43	63.01	62.60	62.18	61.77	61.35	60.93	60.52	60.11	59.69	59.28	58.94	58.77	58.60	58.43	58.26	58.09	57.92	57.75	57.58	57.40	57.23	57.06	57.89	56.64	56.15	55.52	54.70	53.89	53.08	52.26	52.10	
	266.00	65.73	65.49	65.22	64.95	64.71	64.43	64.26	63.84	63.93	63.21	61.92	61.64	61.38	61.82	61.46	60.63	60.17	59.62	59.25	59.08	58.88	58.79	58.66	58.52	58.34	58.10	57.81	57.47	57.32	57.19	57.09	57.09	56.97	56.76	56.54	56.21	54.52	52.07	50.41	50.51	
	00	15	30	45	60	75	90	100	115	130	145	160	175	190	205	220	235	250	265	280	295	310	325	340	355	370	385	400	415	430	445	460	475	490	505	520	535	550	565	580	583	
	0.5																																									

GRAÑA Y MONTERO . BLOCKER S.A.		GMB	
PLANO: PERFIL LONGITUDINAL - CAMINO DE ACCESO			
PROPIETARIO: PETROLEOS DEL PERU			
SUPERVISION: CIA. NAVIERA PEREZ COMPANC			
ESCALA: H = 1/2000 V = 1/200	LEVANT: H. CORNEJO S.	PL N°	POZO N°
FECHA: NOV 1994	REV:	64	7132
DBUJO: J ESPINOZA B	APROB:		

235 A.r. = 0.2
A.c. = 1.0



250 A.r. = 0.6
A.c. = 0.6



265 A.c. = 0.4



280 A.c. = 0.2



295 A.c. = 1.6



310 A.c. = 1.4



325 A.c. = 1.8

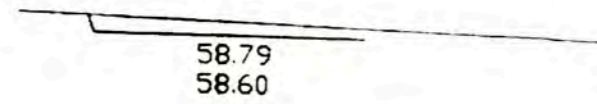

340 A.c. = 2.0

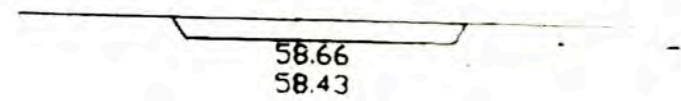

355 A.c. = 2.0

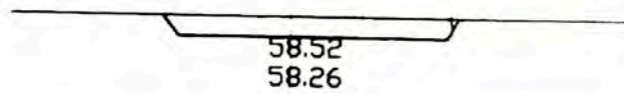

370 A.c. = 1.6

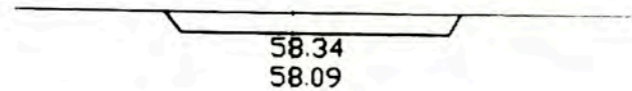

385 A.c. = 1.2

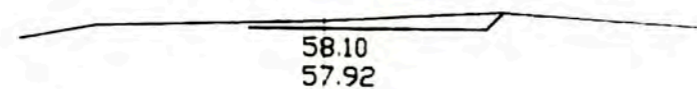

400 A.r. = 0.3
A.c. = 0.3



415 A.c. = 0.4

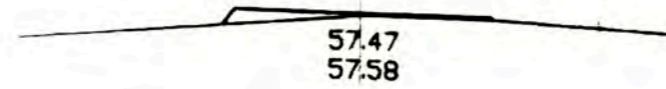

430 A.c. = 0.6

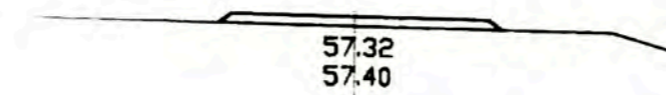

445 A.c. = 0.8

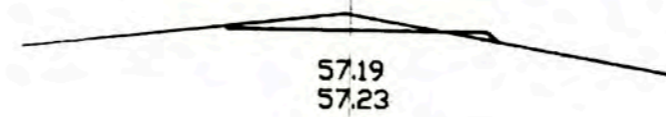

460 A.c. = 1.0

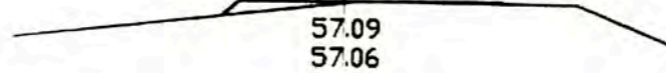

475 A.c. = 1.0

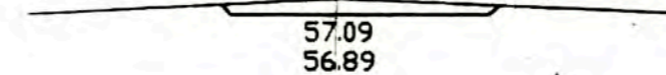

490 A.c. = 1.8

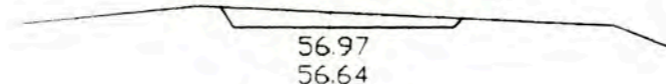

505 A.c. = 4.4



520 A.c. = 7.2

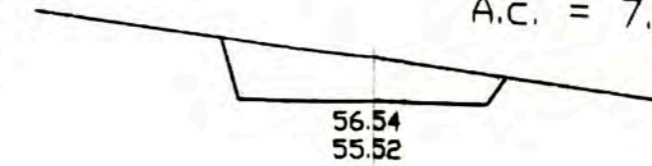

535 A.c. = 11.2

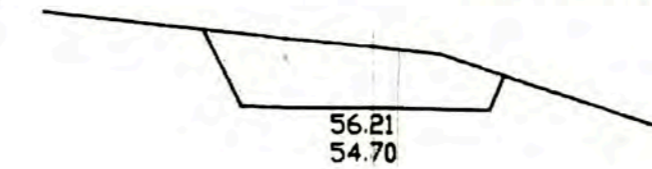

550 A.r. = 1.2
A.c. = 5.0



565 ar = 12.0

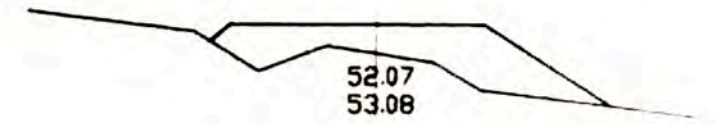

580 ar = 16.2

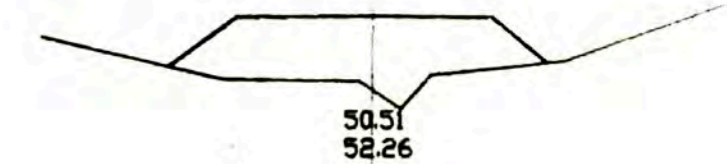

583 ar = 13.2

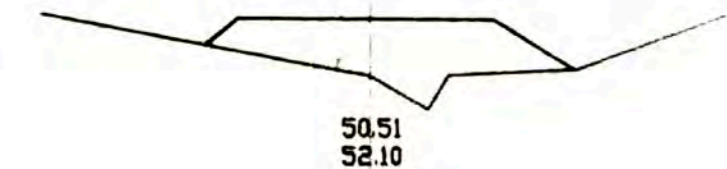

GRAÑA Y MONTERO . BLOCKER S.A.		GMB	
PLANO:			
SECCIONES TRANSVERSALES . CAMINO ACCESO			
PROPIETARIO:			
PÉTROLEOS DEL PERU			
SUPERVISION:			
CIA. NAVIERA PEREZ COMPANC			
ESCALA:	LEVANT:	PL. N.º	POZO N.º
1/200	H. CORNEJO S	25	7100
FECHA:	REV:		
NOV 1994			
DIBUJO:	APROB:		
J. ESPINOZA			

AREA DE PLATAFORMA

PIENTE

-4.0 ‰ x 27.50 m.

SUB-RASANTE	51.10	51.03	50.50	50.00
TERRENO	55.30	55.10	52.40	50.00
METRAJE	0+0	1+50	15+00	27+50

00

A.c. = 4.6

Area de corte PLATAFORMA

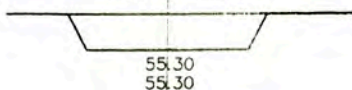

01+5

A.c. = 22.6

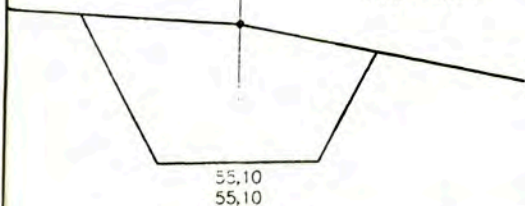

15

A.c. = 8.8

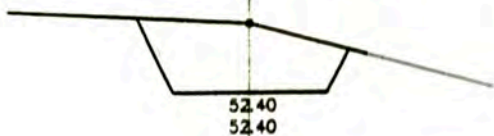

27+5

50.00
50.00



GRAÑA Y MONTERO . BLOCKER S.A.

GMB

PLANO:

PERFIL + SECCIONES - CANALETA DE LODOS

PROPIETARIO:

PETROLEOS DEL PERU

SUPERVISION:

CIA. NAVIERA PEREZ COMPANC

ESCALA:

1/200

LEVANT:

H. CORNEJOS.

PL.N°

70

POZO N°:

7132

FECHA:

NOV 1994

REV:

DIBUJO:

J. ESPINOZA B.

APROB: